

Cluster Living at the Bruyère Village

By: Amy Porteous
November 27, 2014

SOINS CONTINUS
Bruyère
CONTINUING CARE

*Bruyère pour des soins continus.
Bruyère Is Continuing Care.*

Purpose

- To share broadening of care to the Community; the Village model, and its essential components
- To share the innovative cluster model designed for people with mild to moderate dementia

SOINS CONTINUS
Bruyère
CONTINUING CARE

Bruyère Continuing Care

- 269 long term care residents – 2 sites (EBR and RSL)
- 90 rehabilitation beds
- Up to 25 clients at a time in a Day Program
- 331 Complex Continuing Care (SVH)
- 31 Palliative Care (EBR)
- 2 Family Medicine Clinics
- Various Outpatient and Community Programs
- 40 Assisted Living Clients in the Community (ALS)
- 227 apartments as part of the Bruyère Village (70 ALS onsite)

SOINS CONTINUS
Bruyère
CONTINUING CARE

2. Background

SOINS CONTINUS
Bruyère
CONTINUING CARE

*Bruyère pour des soins continus.
Bruyère Is Continuing Care.*

Why?

- Dire shortfall of affordable housing for older adults and assisted living in Ottawa (2007)
 - 1,000 + units required as per Affordable Supportive Housing for Seniors Framework (2007) developed by the United Way and City of Ottawa; increase to 2250 in September 2014
- Inappropriate placement across the entire health system; high alternate level of care figures across Ontario

3. The Bruyère Village Model

What is our vision?

- To provide a continuum of care for seniors allowing them to:
 - remain in their homes as long as possible (e.g. community outreach)
 - provide for different levels of accommodation (e.g. independent living, assisted living, long term care)
 - offer affordable housing
 - maintain healthy lifestyles (e.g. healthy aging programming)

Village Components

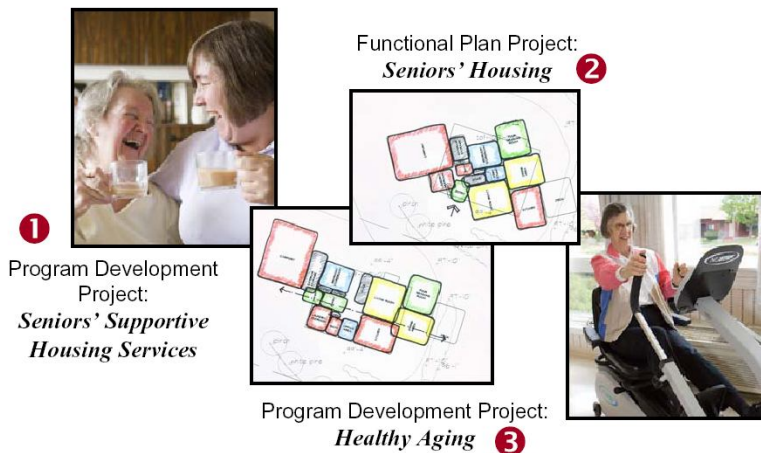

Breakdown of Types of Living Arrangements

Phase	Number of units available
Independent living	33
Independent living affordable	45
Phase One Total	78
Assisted living	113
Cluster Living	36
Phase Two Total	149
TOTAL	227

Assisted Living Services

- The Assisted Living Services for High Risk Seniors Policy, 2010 of the Ministry of Health and Long-Term Care (MOHLTC) – involves the Local Health Integration Network (LHIN), Community Care Access Centre and Agencies
- Providing services to high risk seniors whose needs cannot be solely met on a scheduled basis – to enable them to stay in their own homes to live as independently as possible; and, supports our hospitals and LTC homes to function properly
- Bruyère has been funded by the LHIN for 110 clients

Onsite Services / Amenities

Pharmacy	24 hour emergency service
Physio / OT/ SW / Dietician	Accessibility
Parking	Elevator
Hair Studio/Barber	Laundry facilities
Cafeteria	Gift Shop / Boutique
Chapel	Hobby Room, Multipurpose Room & Theatre, Lounge
Healthy Aging Centre	Ensuite Storage/Lockers
City Bus at entrance	Balcony
Courtyard / Greenspace	Assisted Living Services

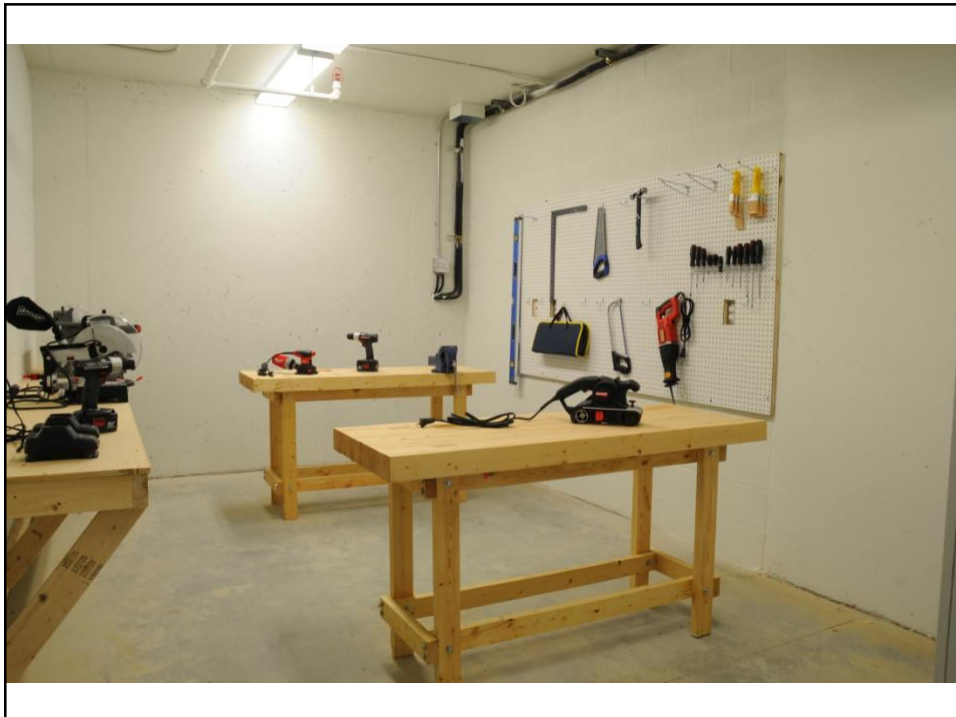

Besserer Place Floor Plan

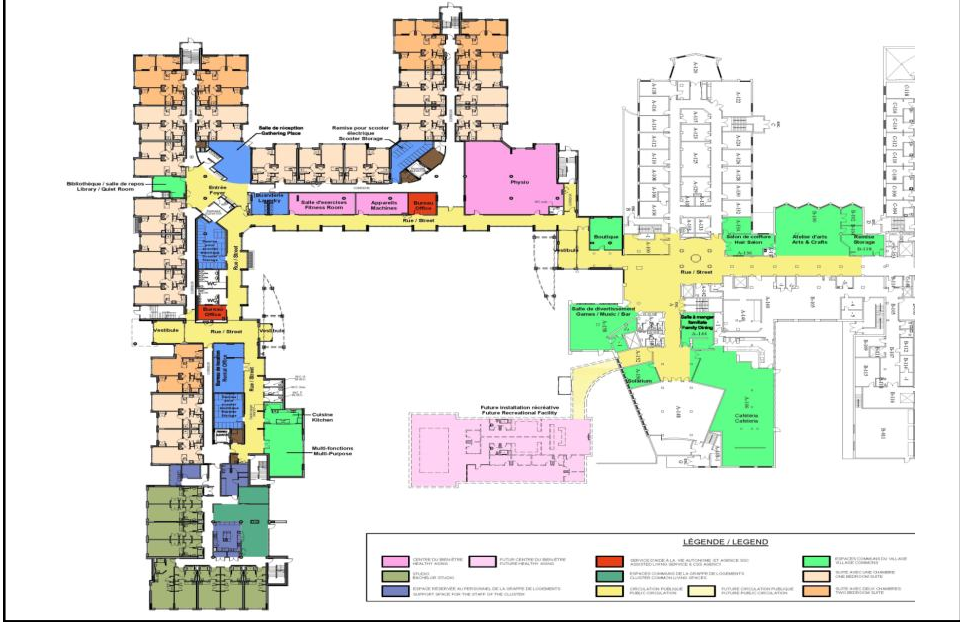

4. Cluster Living



*Bruyère pour des soins continus.
Bruyère Is Continuing Care.*

What is so innovative about it?



Key Elements of the Cluster

- Personal space and various communal spaces
- Provided with base furniture; can provide own personal touches
- Staffed 24 /7
- Tenants involved in meal preparation / clean up
- Staff plan daily activities for each cluster based on interests; encouragement for participation and engagement
- Must qualify for the ALSHRS Program through the Community Care Access Centre

Cluster Design Characteristics

- Built with the client in mind:
 - Accessible – turning radius, sliding doors, roll in showers, wide corridors, spacious, clear passage ways, etc.
- No tripping hazards; no carpets
- Handrails and grab bars in key locations
- Double walls between units to reduce noise
- Enhanced lighting and maximization of natural light
- Blue and beige colours; limit on patterns
- Traditional appliances and furniture

BRUYERE
CONTRACTORS
CONTRACTING CASE



Support for Caregivers

- Monthly caregiver support group, in partnership with the Alzheimer's Society
- Active care coordinator involvement
- Staff that receive training on caring for people with dementia
- Day Program where 3 of the 5 days are for people at home living with dementia

Tenant Stories – The Difference Makers

1. Movement through the entire care continuum – independent to cluster living to palliative care
2. Couples reunited onsite through independent living and LTC
3. Couple in independent living with caregiver supports via Day Program
4. Community of support

Comments / Questions?

SOINS CONTINUS
Bruyère 
CONTINUING CARE

*Bruyère pour des soins continus.
Bruyère Is Continuing Care.*